

Data sheet

Support roller RNA 2200.2RS (crowned, with seal)

Designation	RNA 2200.2RS
Type	crowned
D [mm]	30
d [mm]	10
F, Fw * [mm max.]	14
B1 [mm]	14
B [mm]	13,8
r [mm]	0,6
r1 [mm]	0,3
Dynamic load Crw[N]	7000

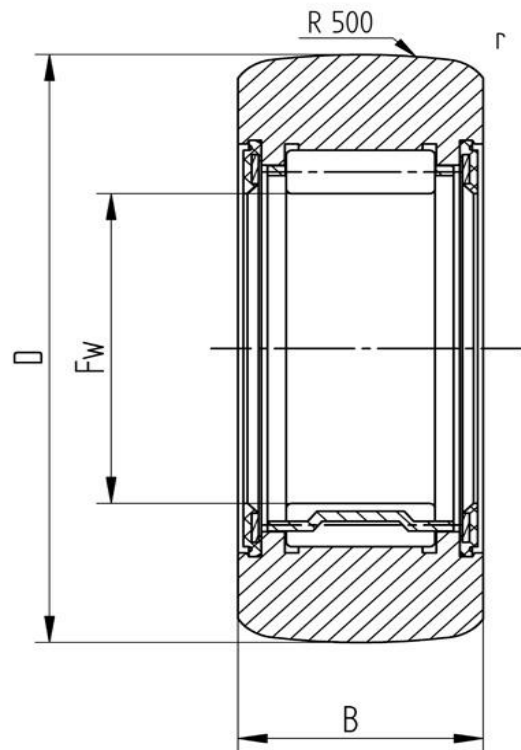

Every specification has been edited and verified carefully. STI Bearings GmbH assumes no liability for potential errors or incompleteness. Technical modifications are subject of changes.
© 2020 by STI Bearings GmbH
Reproduction, even excerpts, only with our approval.